

SERIES S 10 | LINE REGULATOR



- Diaphragm single stage
- Balanced-Valve Technology
- Purity up to 6.0
- Inlet pressure:
25 bar (360 psi)
- Outlet pressure:
3 bar (44 psi)
or 8 bar (116 psi)

- ★ Compact design
- ★ Reduce the ownership cost
- ★ Front panel mounting
- ★ O₂ application compatible

Special requirements on request

APPLICATIONS

- Designed as a second stage line regulator for laboratory applications such as: gas delivery to inductive plasma spectrometer, protection and support gas for chromatograph, environmental emission monitoring, industrial hygiene or safety monitors and trace impurity analyzers.
- Ideally suited as a NH₃ line regulator (EPDM stainless steel version).

KEY FEATURES

- As a second level of regulation, the SL 10 will supply a precise outlet pressure to the process. It can be used for many applications that need a high flow.
- Flexible wall or panel mounting possible with its compact design, the rear threads and fixing ring.
- Best-in-class pressure control with Balanced-Valve Technology: the effect of inlet pressure fluctuations on outlet pressure are minimized. BV-technology delivers an exceptionally stable outlet pressure and flow even with high flow line regulators.
- Longer useful regulator lifetime and lower total ownership cost.

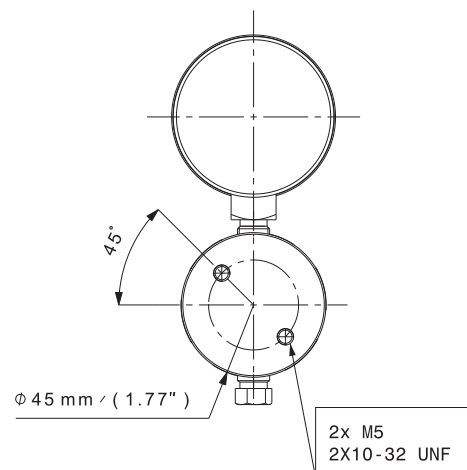
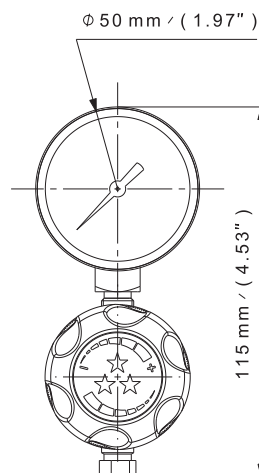
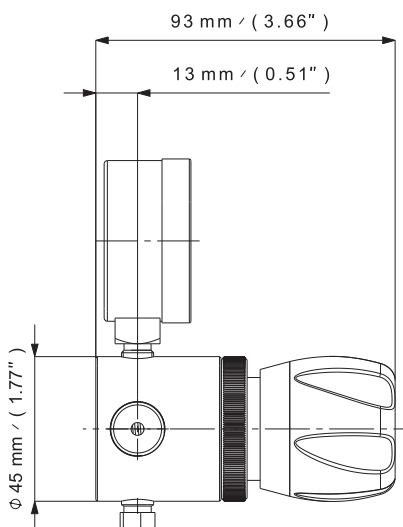

SPECIFICATIONS

| | | | | | |
|---------------------|---|--------------------------|--------------------------------------|---------------------------|----------------------------------|
| Female ports | G 3/8 or 1/4 NPT (inlet/outlet) | Weight | ± 0,6 kg ± 1.32 lbs | Inlet pressure max | 25 bar 360 psi |
| Seat seal | FPM EPDM | Leak rate | 10 ⁻⁸ mbar ℓ/s He | Outlet pressure | 3/8 bar 44/116 psi |
| O-ring | FPM EPDM | Temperature range | - 20°C to + 60°C - 4°F to + 140°F | Nominal Flow | 4,5/12 Nm³/h (N₂) |
| Diaphragm | AlSi 304 (brass version) Hastelloy® (SS version) | Gauges | Low pressure (M10 x 1 or 1/4 NPT) | Oxygen use | OK for brass and stainless steel |

FLOW CURVES

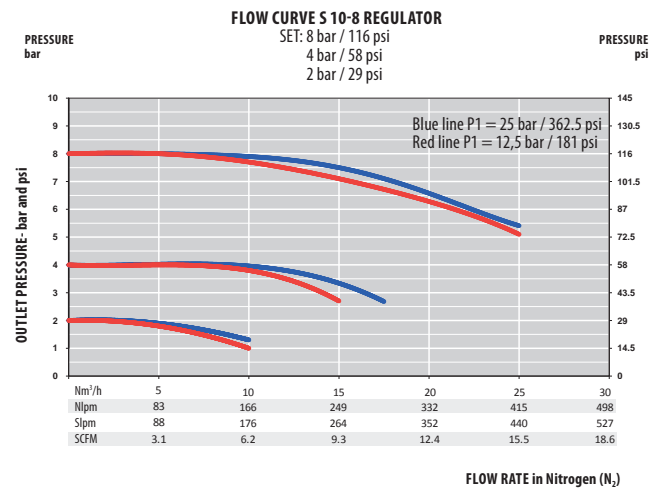
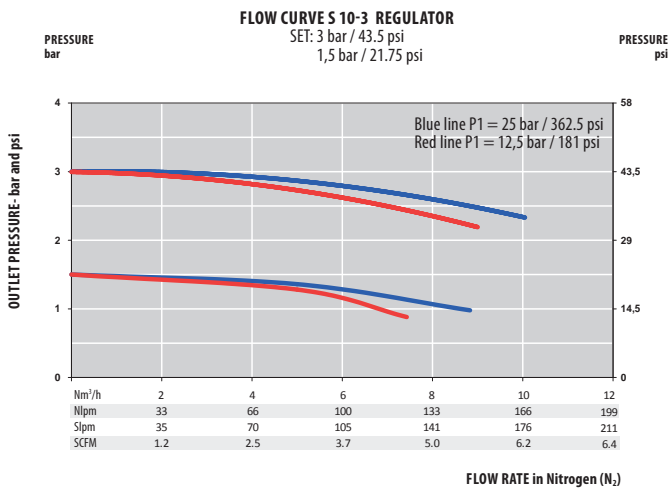

PRODUCT CONFIGURATOR

| Body Material | | 10 | Outlet Pressure | | End Connections | | O-ring Material | | Gauges | | Mounting | | Ports Configuration | |
|---------------|---------------------|----|------------------|---|-------------------|---|-----------------|------|--------|---------------------|----------|------------------------|---------------------|---|
| S | L | | 8 | 3 | G | G | EPDM | 1 | With | 1 | FR0 | FR0 | A | A |
| | Chrome plated brass | L | 3 bar 44 psi | 3 | G 3/8 - G 3/8 | G | EPDM - Standard | With | 1 | Without Fixing Ring | FR0 | Standard Configuration | A | |
| | Stainless steel | I | 8 bar 116 psi | 8 | 1/4 NPT - 1/4 NPT | N | FPM | | | With Fixing Ring | FR1 | Reverse inlet/outlet | R | |