



LEVEL CONTROL

Steam trap KA 6

High pressure valve for small flow rates

Technical data

Connection G	1/2
Max. permissible pressure PS	60 bar
Max. permissible temperature Ts	100 °C
Operating pressure	0 - 60 bar
Flow rate	224 l/h
Temperature range	- 30 up to 100 °C
Medium	liquids and gases

Description

Steam traps automatically drain condensate without loss of steam or gas. They operate instantaneously and are not affected by back pressure or pressure fluctuations. They do not require an external energy input. KA 6 is a float-controlled steam trap specifically for the dehydration of gases. It is particularly effective in oxygen or hydrogen applications in electrolysis processes or compressors. It is completely made of stainless steel with excellent corrosion-resistance. The valve is fitted with a metallic seal. The simple design makes it easy to specify, install, handle and service these valves in an industrial environment. Maintenance can be performed quickly and without special tools. These valves are no shut-off elements ensuring a tight closing of the valve. In accordance with DIN EN 60534-4 or ANSI FCI 70-2 they may feature a leakage rate in closed position in compliance with the leakage classes IV (metallic-sealed 0,01 % Kvs value).

Standard

- » All stainless steel construction
- » Compensation line connection
- » Purging connection made of 1.4404
- » Vertical or horizontal flow direction – Please specify with your order!

Options

- » Various seal materials suitable for your medium
- » Special connections: flange according to EN 1092-1, ASME B16.5, NPT threads, welding ends, other connections on request
- » Special versions on request

Product



Picture similar

Technical specification

Pressure ranges [bar]

0 - 60

Flow rate [l/h]*

Δp bar	1	2	5	10	20	30	40	50	60
l/h	32	44	68	95	132	161	185	205	224

*Cold condensate (20°C)

LEVEL CONTROL Steam trap KA 6

High pressure valve for small flow rates



Materials

Materials*

1 Body	Stainless steel 1.4404 / 1.4571 / 316L
2 Body seal	FKM (optional FEPM, EPDM)
3 seat	stainless steel 1.4404 / 316L
4 Seat gasket	metallic, stainless steel 1.4404 / 316L
5 Float	stainless steel 1.4404 / 316L

*All materials equal or of higher quality

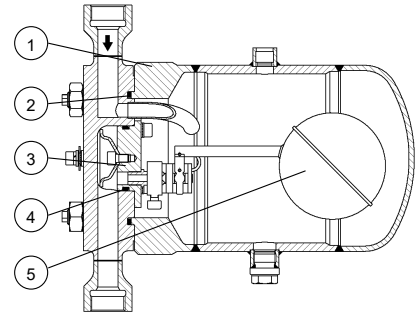

Dimensions and weights

Dimensions [mm]

size	nominal diameter
	G 1/2
A*	230
B*	230
C	120
D	180

*overall length tolerances in acc. with DIN EN 558

Weights [kg]

	G 1/2
	12

Customs tariff number

	84818059
--	----------

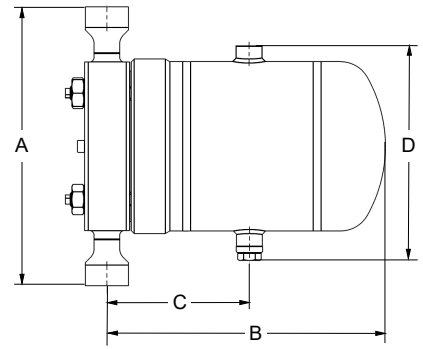

Recommended installation

Horizontal installation

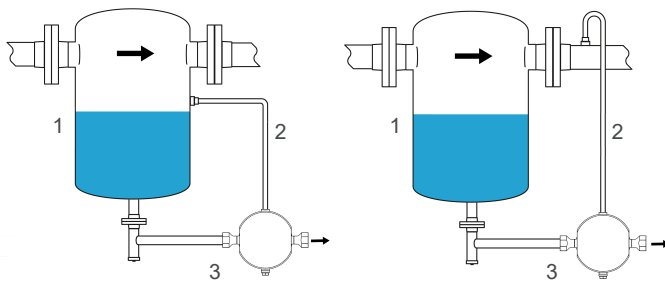

Vertical installation

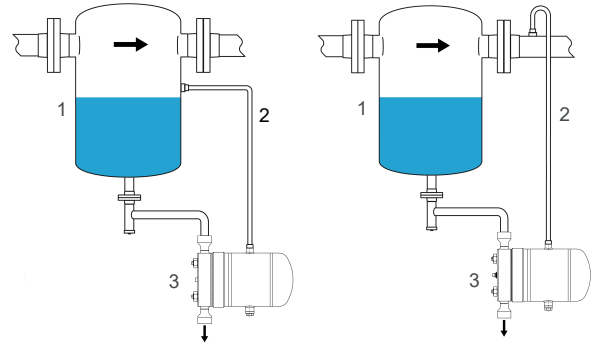

1 Condensate collection tank 2 Compensation line 3 Steam trap

Please send us your enquiry and allow us to advise you. Special designs on request.
The pressure has always been indicated as overpressure. Mankenberg reserves the right to alter technical specifications without notice.

Mankenberg GmbH
Spenglerstrasse 99
D-23556 Luebeck | Germany

Phone: +49 (0) 451-8 79 75 0
Fax: +49 (0) 451-8 79 75 99

info@mankenberg.de
www.mankenberg.com

